



Control Number: 43912



Item Number: 1

Addendum StartPage: 0

2014 DEC -5 PM 1:56

**Certification Form for Renewable Energy Credit Generators**

FILING CLEAR

**Information about Generating Unit(s)**

1.	Facility Name or Description	Route 66 Wind Power
2.	Street Address or Legal Geographical Location	Farm-to-Market Road 2161 Panhandle, TX 79068
3.	Name of Owner	Route 66 Wind Power, LLC
4.	Owner PUC Registration (for Subst. Rule §25.109)	Pending
5.	On-site Contact Person (if applicable)	Carter Scott, Compliance Admin Project under development, please use prior to on site operations. cscott@firstwind.com, or regulatory@firstwind.com
6.	On-site Telephone Number (if applicable)	Carter Scott Project under development, please use prior to on site operations. 207-228-6864
7.	Type of Renewable Generating Technology	<input type="checkbox"/> Biomass <input type="checkbox"/> Hydroelectric <input type="checkbox"/> Solar <input checked="" type="checkbox"/> Wind <input type="checkbox"/> Other (specify):
8.	Fossil Fuels Used (if any)	<b>None</b>
9.	TNRCC Air Permit Number (if any)	N/A
10.	Meters (ISO Numbers or Other Identifiers)	TBD
11.	Percentage to be Subtracted from Annual Metered Generation	0
12.	Metered Generation Eligible for Renewable Energy Credits (in MW)	150 MW

13.	Please complete the following for each generating unit operating at this facility. Include additional pages as necessary. For sites with large numbers of individual units, complete the attachment entitled "List of Generating Units at Facility" and enter "See attached list" in the first three blanks of this section. For older units upgraded and repowered after Sept. 1999, include one page describing the unit before the upgrade, and another page describing the incremental addition to capacity resulting from the upgrade.	
Manufacturer	Vestas 2.0 MW	
Serial Number(s)	TBD	
Date Commercial Operation Began / Will Begin	8/2015	
Total Rated Nameplate Capacity	150 MW	
Is this a fossil fuel unit that has been or will be repowered to use a renewable fuel?	Yes _____ No <input checked="" type="checkbox"/>	
Is this unit developed as part of an emissions reduction project described in Health and Safety Code §382.05193, that is being used to satisfy the permit requirements in Health and Safety Code §382.0519?	Yes _____ No <input checked="" type="checkbox"/>	
<p>If the generating unit is owned by or under contract to a utility, an electric cooperative, municipally-owned utility, competitive retailer, or river authority, is any portion of this unit's above-market costs included in the rates of any utility, municipally owned utility or distribution cooperative through base rates, a power cost recovery factor, stranded cost recovery mechanism or any other fixed or variable rate element charged to end users?</p> <p>If the answer is "yes" at the date this application is filed, state the date when the answer would become "no." Provide documentation to support this change of status.</p>	<p>Yes _____ No <input checked="" type="checkbox"/></p> <p>Date _____</p>	
Does this unit qualify for Renewable Energy Credit Offsets?	Yes <input checked="" type="checkbox"/> No _____	

Name, Mailing Address and Telephone of Generating Facility Owner

Route 66 Wind Power, LLC  
c/o First Wind Energy, LLC  
179 Lincoln Street, Suite 500  
Boston, MA 02111  
617-690-2888

Name, Mailing Address and Telephone of Owner's Designated Representative

Carter Scott, Compliance Administrator  
or Hallie Flint Gilman, Associate General Counsel  
regulatory@firstwind.com  
207-228-6864  
First Wind Energy, LLC  
179 Lincoln Street, Suite 500  
Boston, MA 02111

Name, Mailing Address and Telephone of Alternate Representative

Christopher Reeder  
Lacey Watson  
  
HUSCH BLACKWELL LLP  
111 Congress Avenue, Suite 1400  
Austin, TX 78701-4093  
  
Direct: 512.370.3436

I certify that I have reviewed and will comply with the provisions in Section 14, "Renewable Energy Credit Trading Program" of the ERCOT Protocols. I certify that the information presented in this Certification Form is correct. I further certify that the generating facility owner (or designated representative) shall inform the Project Administrator of any change that renders the information contained in this certification obsolete, and that such notification will be provided in writing no later than 30 days after the change is discovered by the owner.

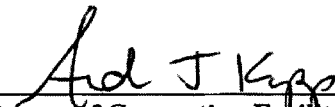
  
\_\_\_\_\_  
Owner of Generating Facility or Designated Representative

12/5/2014  
\_\_\_\_\_  
Date

**List of Generating Units at Facility**

Manufacturer and Make	Serial Number(s)	Date Commercial Operation Began/Begins	Capacity per Unit (in MW)	Number of Units	Capacity (in MW)
Vestas	TBD	10/2015	2	75	150

## **Map showing Generation layout**

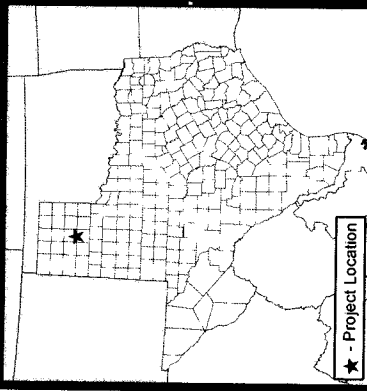

★ - Project Location

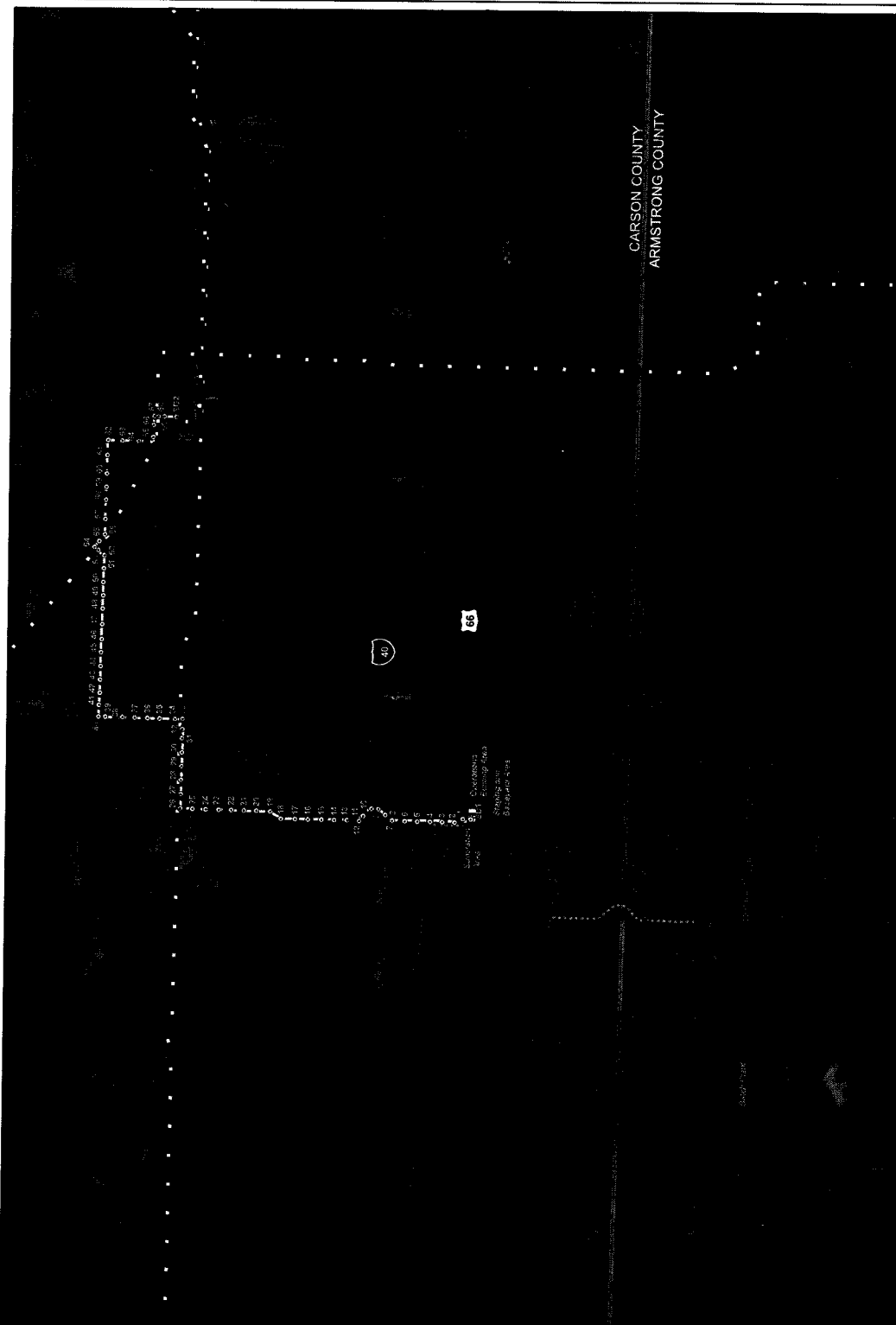

CARSON COUNTY  
ARMSTRONG COUNTY



Imagery ©2014, DigitalGlobe, Landsat, Texas Orthomagnery Program, U.S. Geological Survey, USDA Farm Services Agency

- Primary Turbine - V110 - 2.0
- Permanent Met Tower
- T-Line Structure
- Proposed Substation
- Proposed O&M
- Staging and Baseyard Area
- Proposed Batch Plant
- Albates Existing Substation
- Participating Parcel
- Proposed Access Road
- Proposed Collection Line
- Proposed Crane Walk
- Proposed 345 kV Double Circuit T-Line
- CREZ Transmission Line
- XCEL Transmission Line
- Major Roads
- Local Road
- County Line

# Route 66 Wind Project

Armstrong and Carson Counties, Texas

## Site Plan

Current as of December 04, 2014



**Westwood Professional Services, Inc.**  
 1998 Arapahoe Drive  
 Eden Prairie, MN 55344  
 PHONE: 952-837-6100  
 FAX: 952-837-6101  
 TOLL FREE: 1-888-937-5700  
 www.westwood.com



DATA ARE PRELIMINARY -- NOT FOR CONSTRUCTION